

CAMPO 14

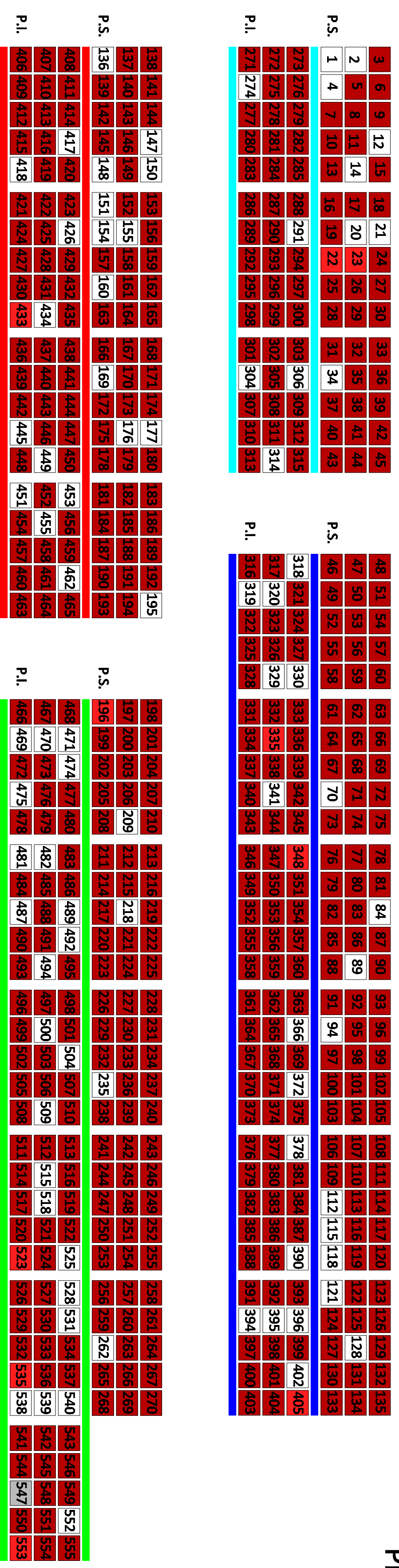

Plano Seminterrato

CAMPO 14

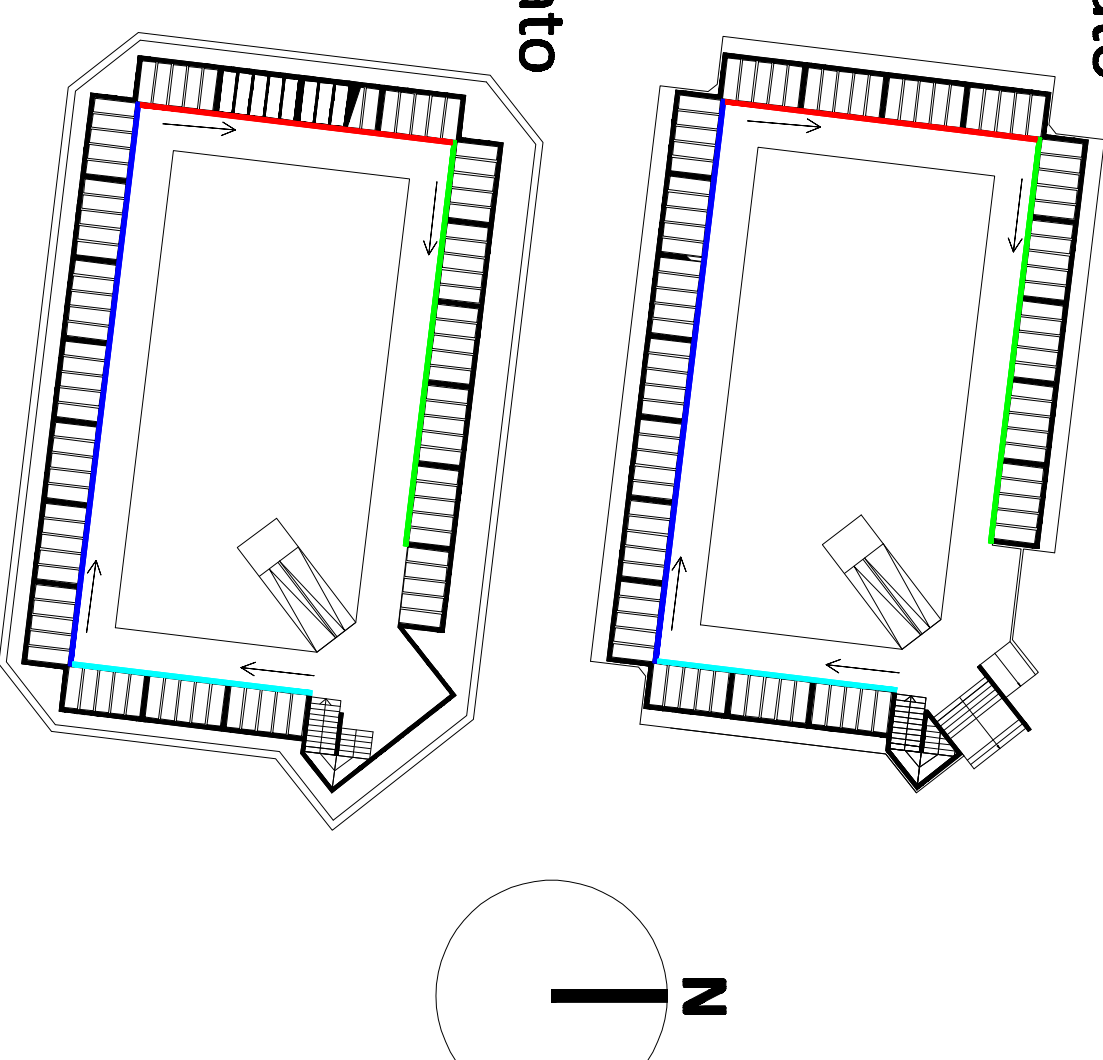

Plano Interrato

CAMPO 17

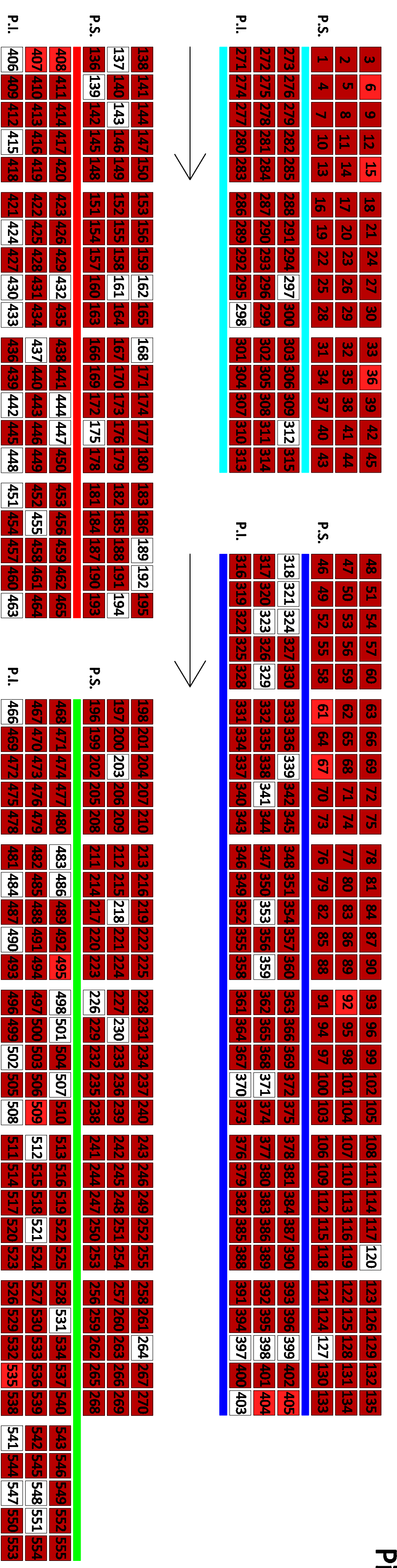

Plano Seminterrato

CAMPO 17

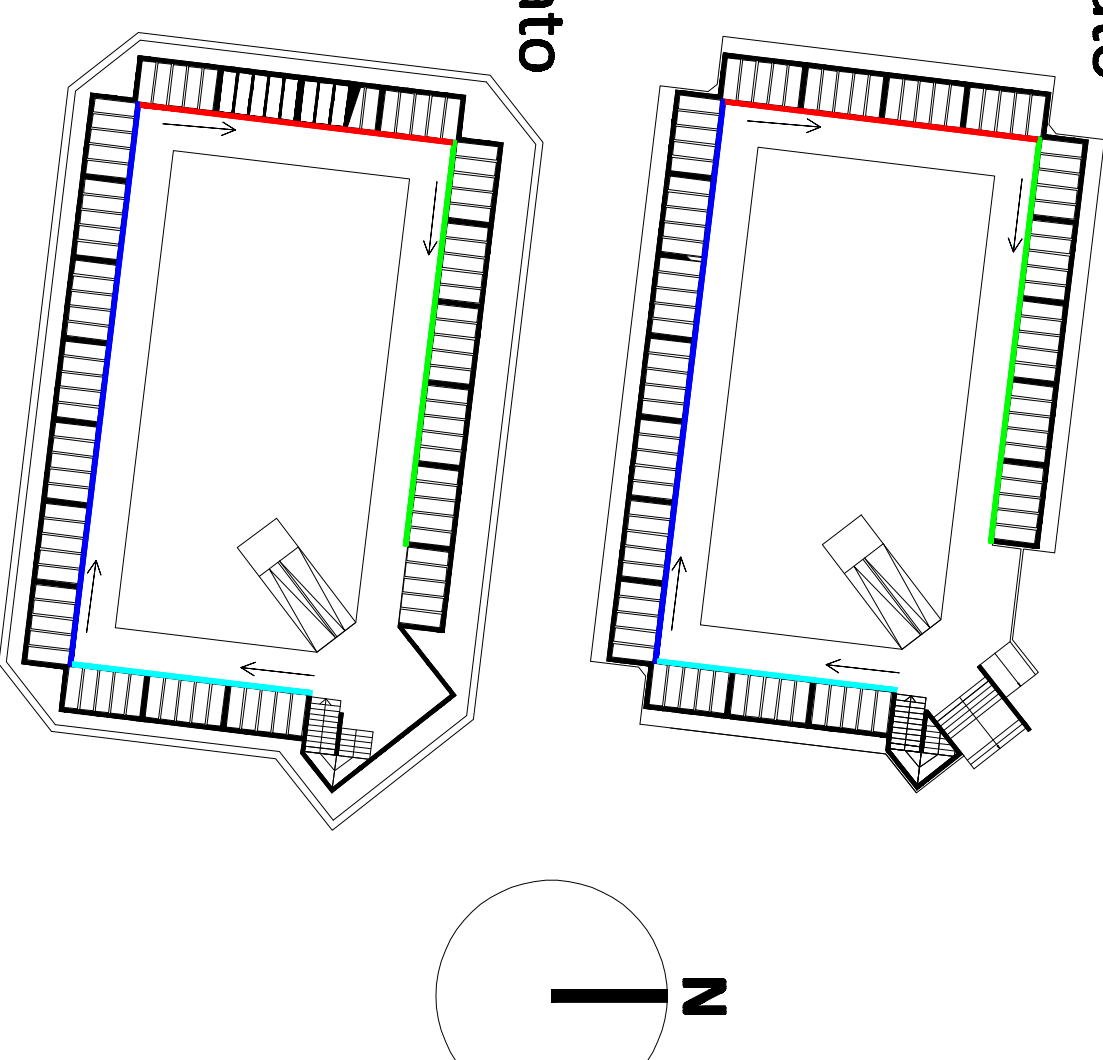

Plano Interrato

CAMPO 20

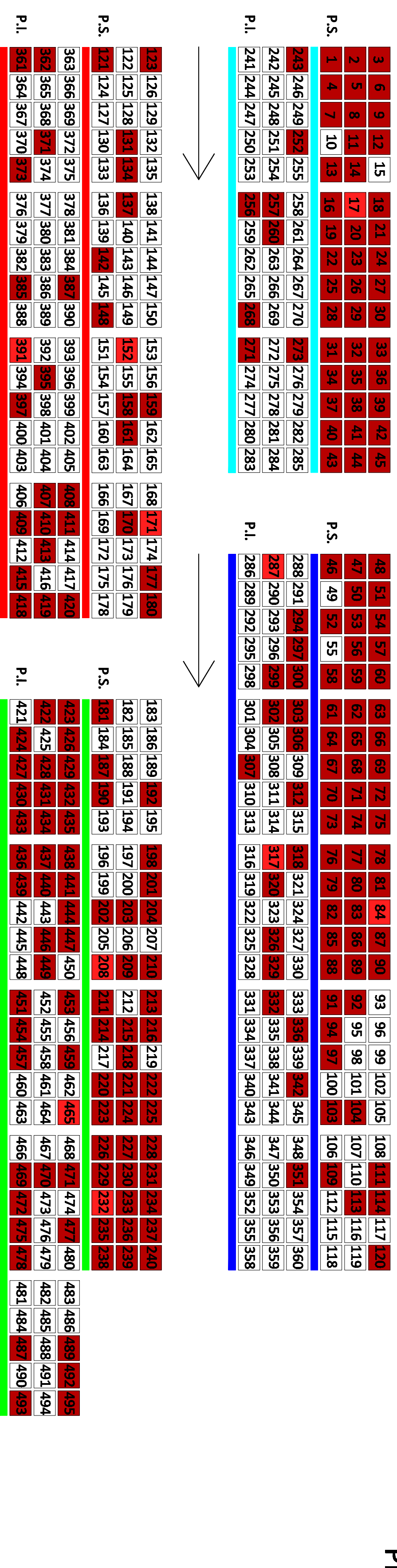

Plano Seminterrato

CAMPO 20

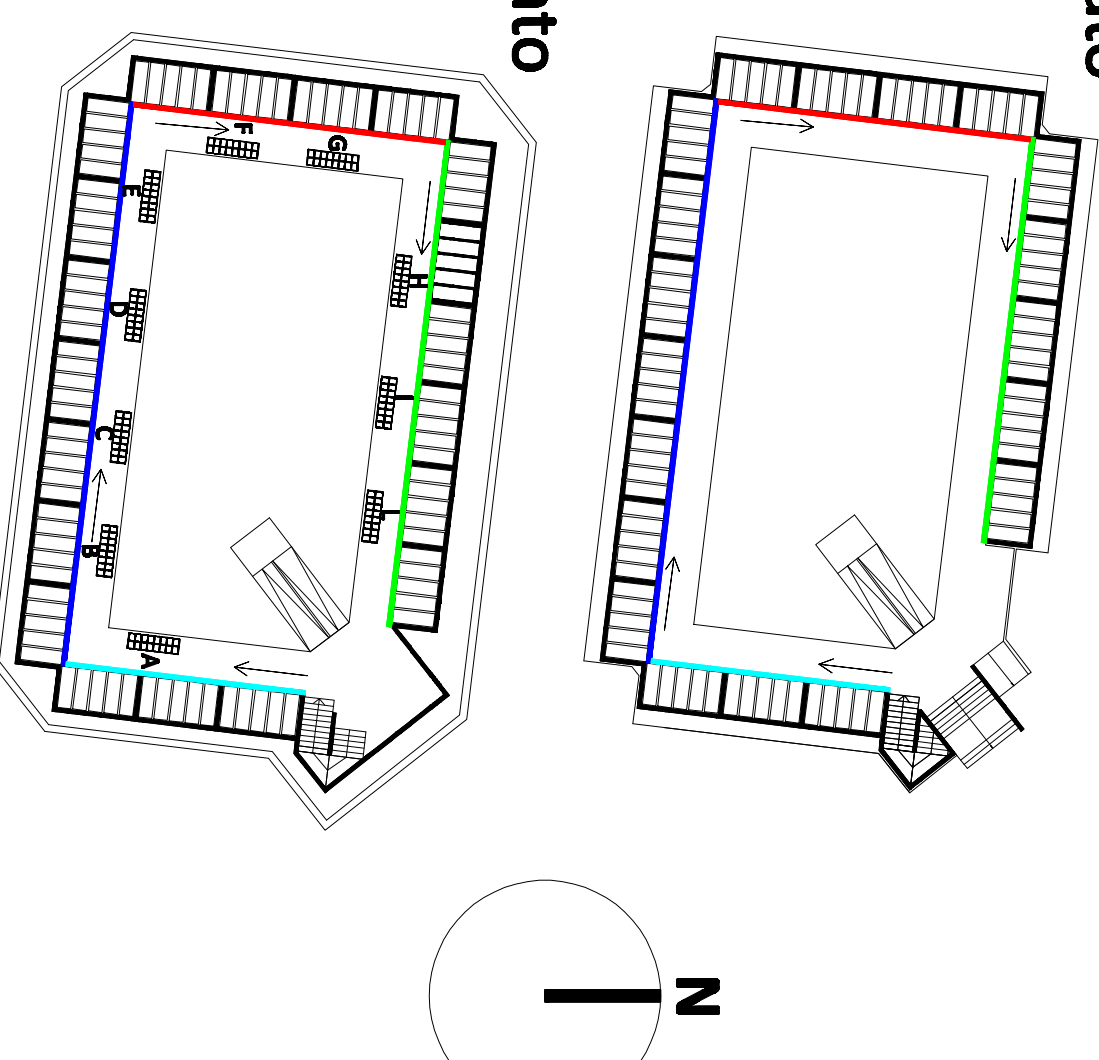

Plano Interrato

CAMPO 22

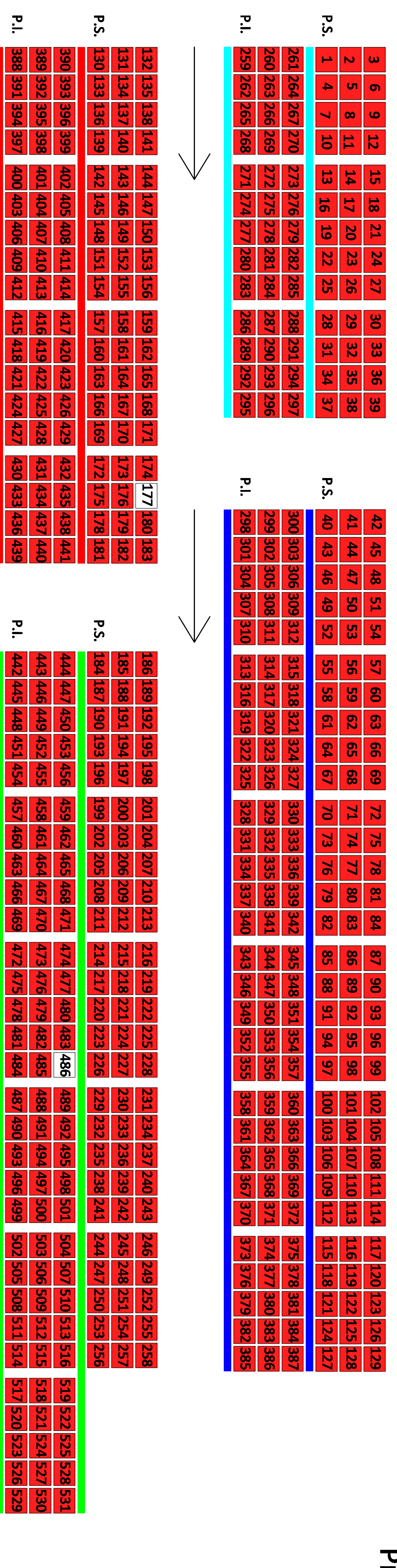

Plano Seminterrato

CAMPO 22

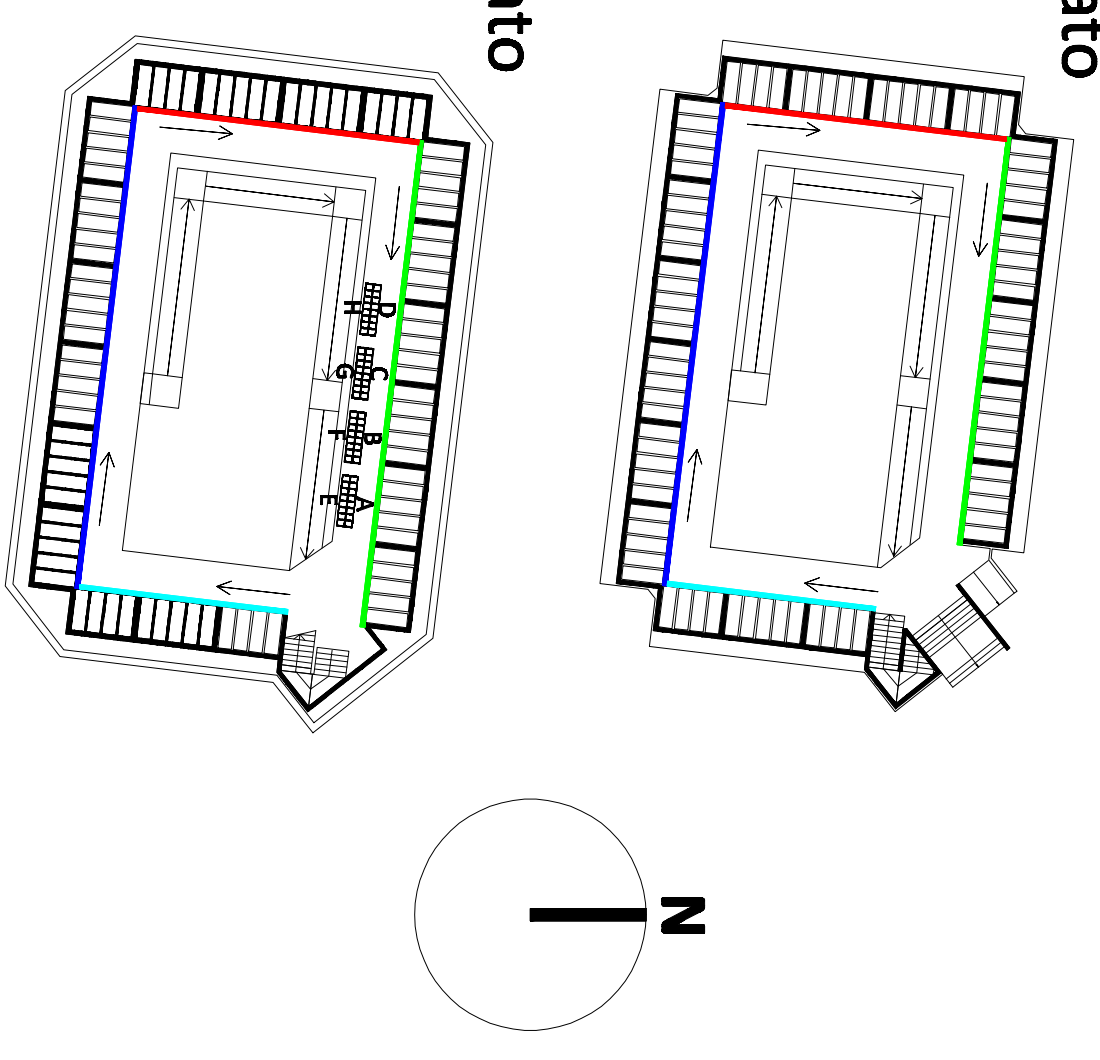

Plano Interrato

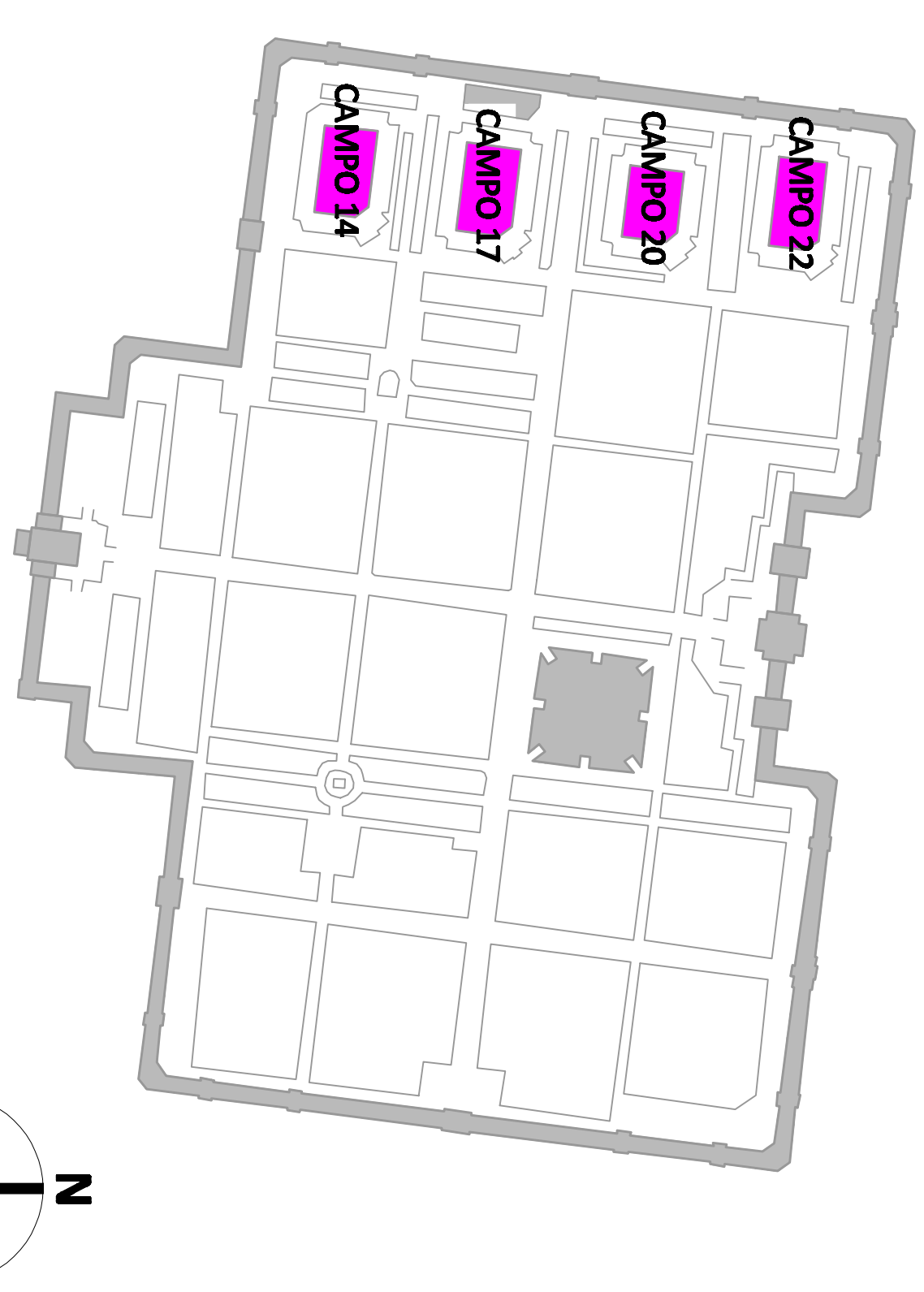

LEGENDA:

- Concessione 30 anni
- Concessione 50 anni
- Concessione 99 anni
- Concessione perpetua
- Loculi/colombari
- Ossari

OSSARI CAMPO 17

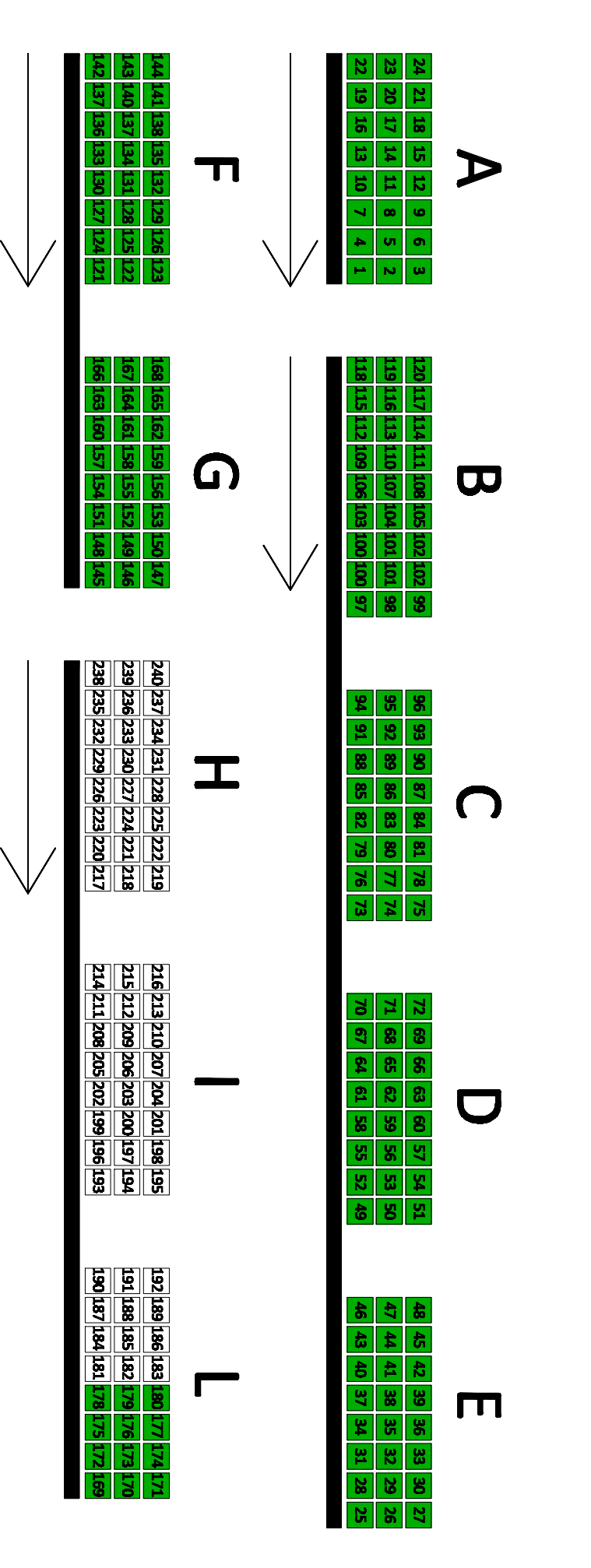

OSSARI CAMPO 20

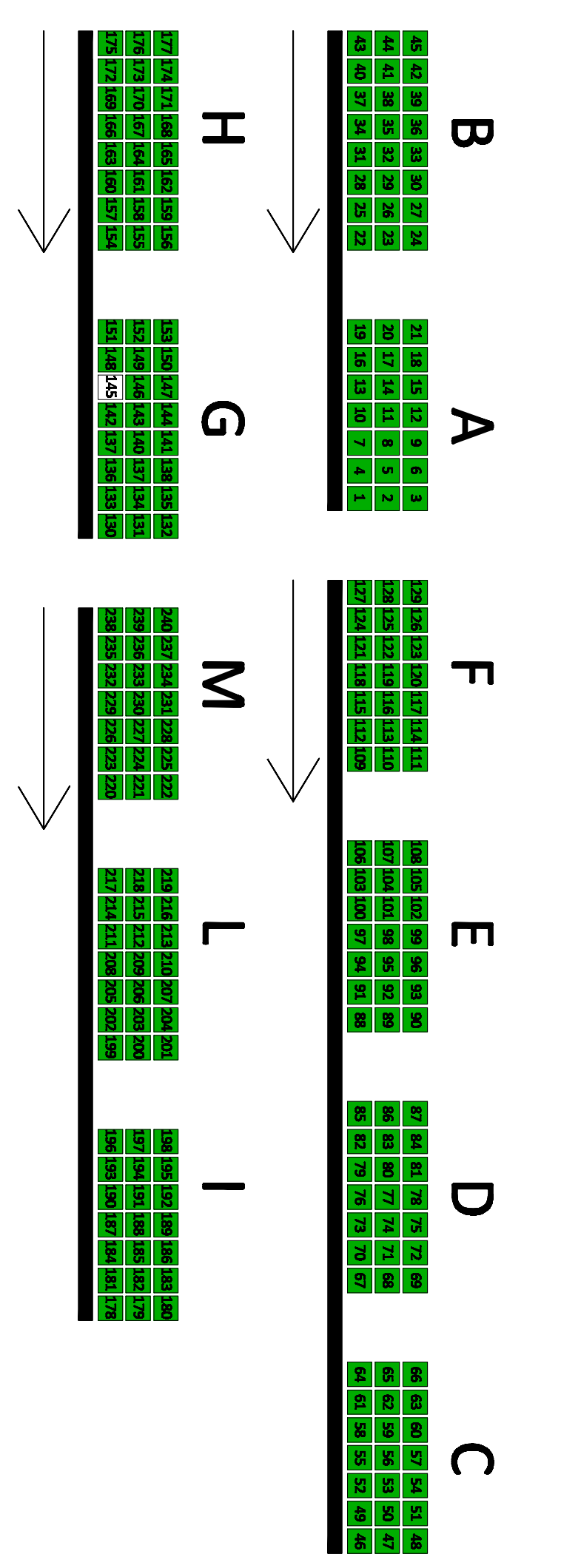

OSSARI CAMPO 22

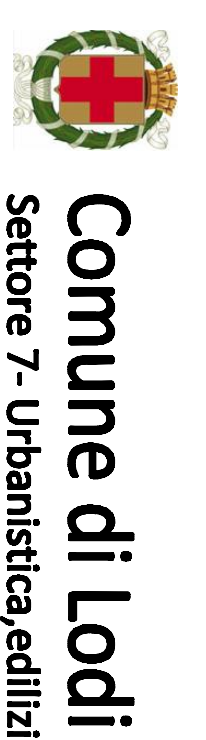
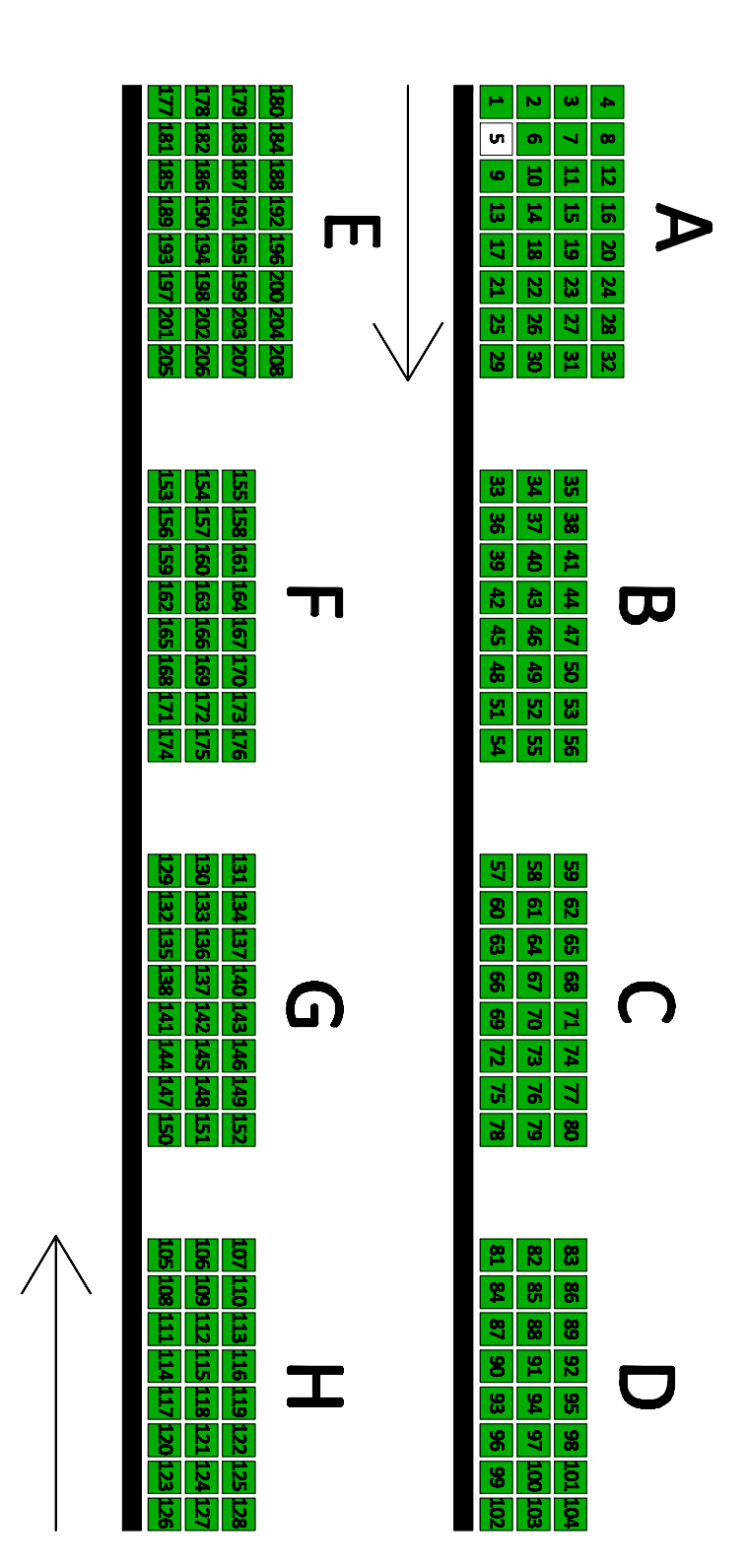

Comune di Lodi
Settore 7 - Urbanistica, edilizia, manutenzione del patrimonio

Progetto: PIANO CIMITERIALE

Tecnico: **Dott. Ing. Michele Scola** - Camera di Registro -
Scala: **1:1000**

Tavola n. **9a**

Progettista: **Ufficio tecnico Comune di Lodi**
Dott. Ing. **Michele Scola**

Direttore: **Dott. Ing. Giovanni Liggi**

Adattato con delibera del C.C. n. **10** del **12/01/2010**
Approvato con delibera del C.C. n. **10** del **12/01/2010**

Elaborato digitalmente da: **Francesco Ghilardi**
T. **10/01/2010**
F. **10/01/2010**
Progetto: **Comune di Lodi**